

## IMPORTANT SAFEGUARDS

When using electrical appliances, basic safety precautions should always be followed!

### READ ALL INSTRUCTIONS BEFORE USE

1. Do not operate Silver Twister Corkscrew with a damaged cord or plug, after the appliance malfunctions or if it is dropped or damaged in any way.
2. To protect against risk of electrical shock, do not put the Silver Twister Corkscrew in water or other liquid. This may cause personal injury and/or damage the product.
3. To protect against fire, do not operate the unit in the presence of explosive and/or flammable fumes.
4. Do not use the Silver Twister Corkscrew for other than intended use.
5. This product is intended for normal domestic household use only.
6. When using or recharging the Silver Twister Corkscrew keep your workspace clean and free from potential hazards.
7. For indoor use only. Do not expose the Silver Twister Corkscrew or charging unit to rain or other extreme conditions.
8. Never force the Silver Twister Corkscrew onto a bottle or attempt to speed up the mechanism. The Silver Twister Corkscrew will work best when it is operated at its intended speed.
9. Do not touch or adjust the Silver Twister Corkscrew mechanism or the corkscrew spiral. Only hold the Silver Twister Corkscrew by its housing.
10. Do not attempt to open bottles if the switch is not working correctly.
11. Do not attempt to open the Silver Twister Corkscrew it has no serviceable parts.
12. Only recharge the electric wine opener using the recharging unit and power cord supplied.
13. Never remove the plug from the socket by pulling the power cord.

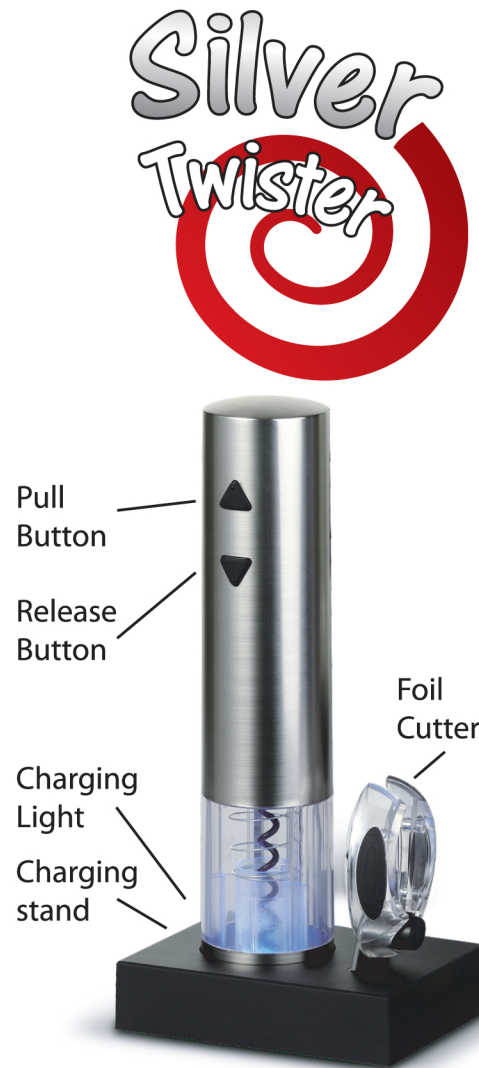

**CAUTION:** Corkscrew is sharp. Handle carefully. Keep hands and utensils out of the container while operating to prevent the possibility of severe personal injury and /or damage to the product or property. Before you use this product for the first time, please take a few moments to read these instructions and keep it for reference.

## OPERATING INSTRUCTIONS

We recommend that you charge your Silver Twister Corkscrew for at least 8 hours before using it for the first time. Please follow the instructions for recharging below:

Recharging your Silver Twister Corkscrew will take approximately 6-8 hours. Plug the adapter cord into main socket on back of charging station and place the Silver Twister Corkscrew on charging station. Charging light will on, that means the charging is on progress. Fully recharged can last for opening approx. 40 bottles.

### To operate your Silver Twister Corkscrew

1. Before remove the cork you must remove any foil from the bottle, using the provided foil cutter.
2. Place the Silver Twister Corkscrew on top of the wine bottle making sure that it remains upright all the time. If you hold the Silver Twister Corkscrew at an angle to the bottle it will not remove the cork properly.
3. Hold the Silver Twister Corkscrew firmly and press the Pull Button, the corkscrew spiral will turn in a clockwise direction and enter the cork. Then gradually remove it from the bottle. When the Silver Twister Corkscrew mechanism will stop, the cork will be removed from the bottle.
4. Lift the Silver Twister Corkscrew away from the bottle, press Release Button and the the cork will be removed from Corkscrew.
5. Always return the Silver Twister Corkscrew to the charging station when finished with it. This will protect the mechanism while it is not in use.

### Importer:

Handlosfera.pl sp. z o.o.  
Gutkowo 79a  
11-041 Olsztyn, POLAND

